

The SK is a key driven electrical switch interlock ideal for the controlled isolation or switching of low current. This product is used to release a key and the switch contacts change to isolate the process. This type of isolator should be used for short term, off load isolation. The unit is ready for mounting into an existing panel or for surface mounting within its own IP65 rated enclosure. The SK is manufactured from either brass or stainless steel.

OPERATION

The SK switch key lock is typically used for machine isolation in order to protect the hazardous area from access while power is on.

SK switch key interlock, back on panel mounting

1 Key is trapped while power is on.

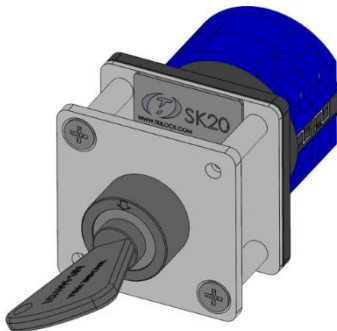

While the power is on and a machine is running, the key is trapped in the switch key interlock.

2 Turn and remove key to switch the power off by changing the contacts arrangement.

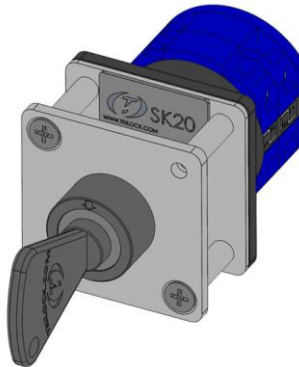

By turning and removing the key from the switch, the contacts condition in the SK changes, switching the power off.

3 Key is free, power is off.

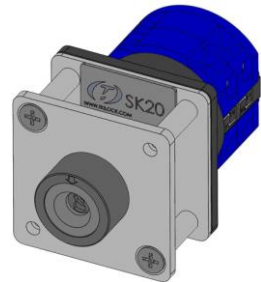

The key can now be removed and taken to unlock the door interlock and gain access to the machine area.

The SK is available with different switching loads as SK20, SK32 or SK63(20,32, or 63 amps control isolation respectively (see order information on page 6 for more details).

The SK comes with 4 or 6 contacts as standard with contacts arrangements as 2NO/2NC, 4NC or 3NO/3NC or 6NC.

The SK is available as a back of panel mount and as a surface mount version with an enclosure.

USAGE

The SK switch key interlock is designed to be part of a safety system and is used to isolate the power releasing.



The SK switch key interlock is not designed for security purposes.

No hazardous substances were used in the manufacture of this product. The product can be disposed of in standard waste.

INSTALLATION

Back of panel units should be mounted to a flat surface using suitable fasteners (please refer to drawing on page 4 for more details). The lock face should be sealed to the panel for ingress protection.

Cables should be connected to the switch in accordance with the applicable wiring diagrams. Ensure that the unit is bonded for earth continuity (see drawing on page 4 for more installation details).



IMPORTANT: The SK switch key interlock should be mounted on the guard using anti-tamper fasteners to prevent unauthorized removal.



The SK switch key interlock must be installed by a competent and qualified person who has read and understood these instructions. Please retain this document in your technical file.



The manufacturer should be consulted when use in a corrosive environment is planned.

MAINTENANCE

Periodic visual checks should be carried out by the site manager/safety officer.

Do not lubricate lock barrel with oil or grease, use WD40 or CRC5-56 if necessary.



The interlock must be inspected every 6 months. Safety checks should include ensuring the keys can only be removed in the correct safety operating conditions (see page 1).



In case of defects being detected please contact your nearest ARMADILLO Support Department for further actions. Please see Contact section for contact details.

TECHNICAL DATA

Temperature rating	-25°C to 55°C
Type of mounting	Surface mount using suitable fasteners (please refer to drawing on page 4 for more details)
Weight	SK20: Front of board mount = 0.8 kg / back on board = 0.6 kg
Material	Brass/Stainless steel, Polycarbonate box for front of board version
B10d	2,500,000
Shock & vibration	EN 60068
Switch protection	IP65, for enclosure unit only
Switch parameter	690V, 20A (standard for SK20), 32A and 63A options available, IEC 60947
PL rating	PLe

APPLICATION

An SK switch key interlock safety component is typically used as part of an integrated safety system.

A typical application of SK switch key interlock is machine guarding. It is usually used in combination with an access interlock such as the SM door lock for part body access or an access interlock with an exchange key for full body access control such as SML access interlock.

The SK breaks the machine safety circuit ensuring a machine is shut down. The key can then be taken to the SML access interlock to enable access to the machine.

The machine cannot be restarted until the door is closed, the bolt is trapped in the SML access interlock, and the key is removed and taken to the SK.

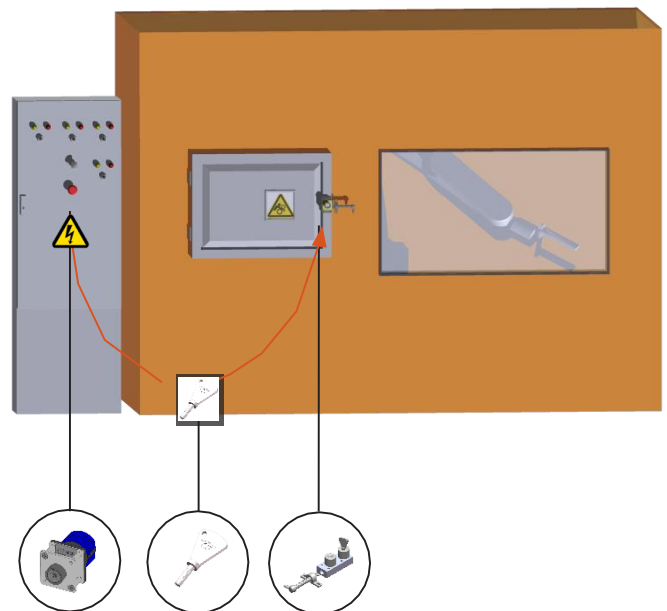

DRAWING

Note: For safe mounting, use security screws

SK, Panel mount (Back of board)

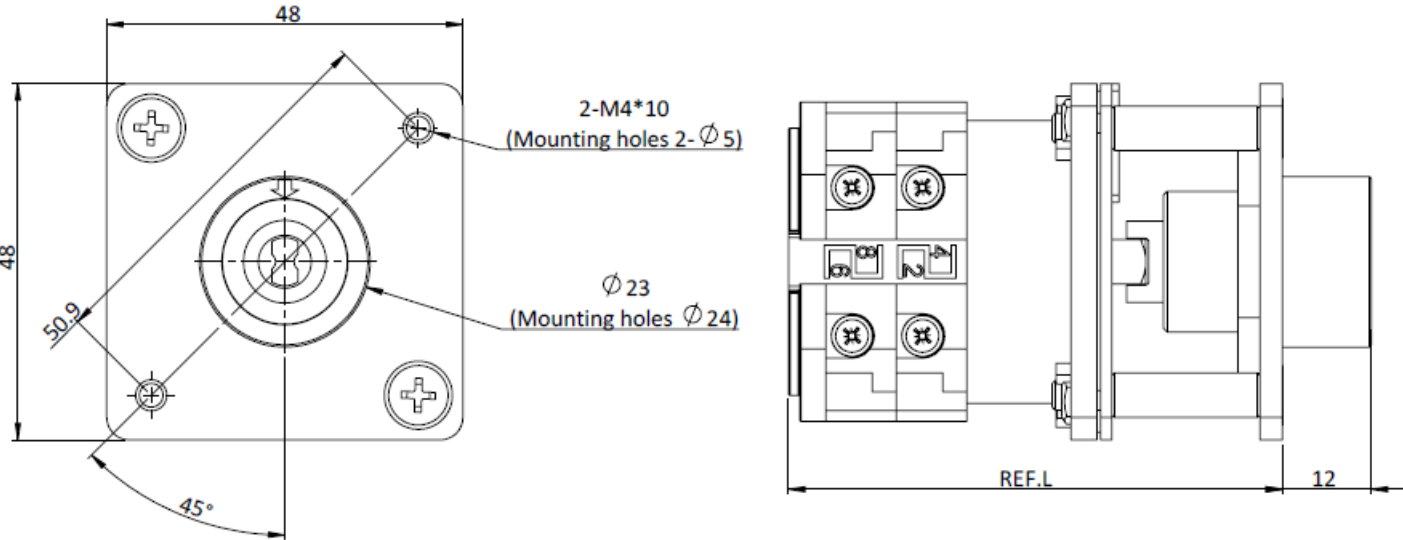

DIMENSION REFERENCE "L"	
NO. of POLES	LENGTH
4 POLES	67mm
6 POLES	76.5mm
8 POLES	86mm
10 POLES	95.5mm
12 POLES	105mm

SSK, Surface mounting (Front of board)

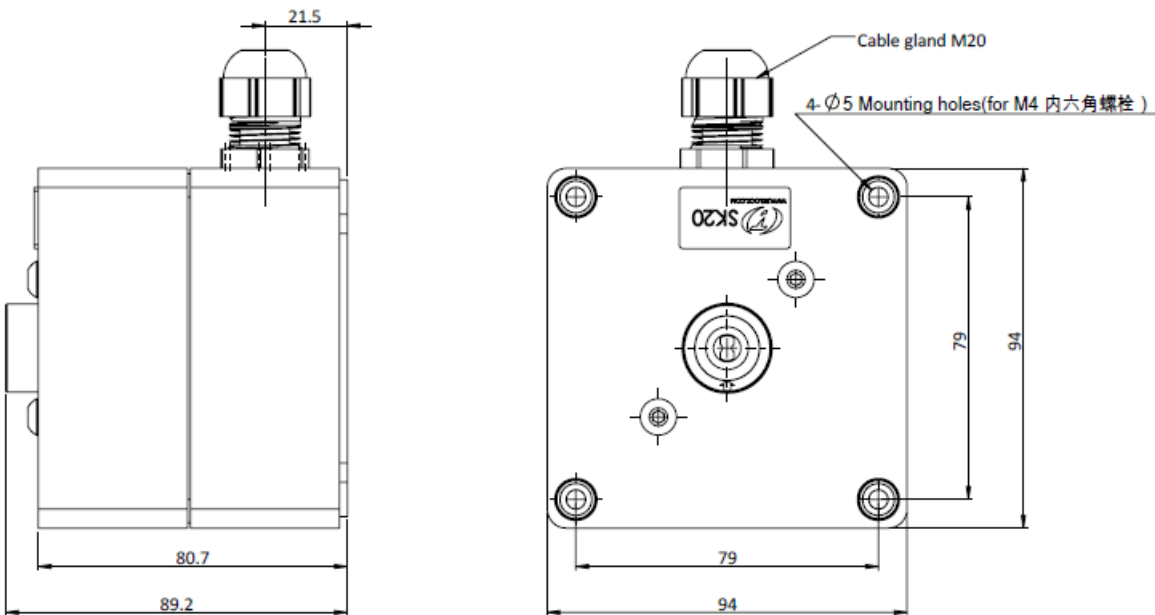

WIRING DIAGRAM

Note: For safe mounting, use security screws

SK, Key Free, Switch off (4 NC)

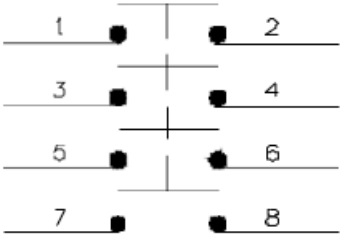

SK, Key Free, 2 NO / 2 NC

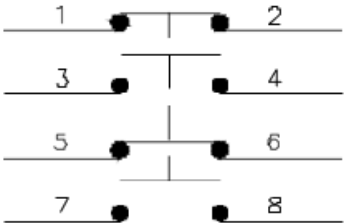

ORDER INFORMATION

	Component type		1	2	3	4			
Part number	SK	-	-	-	-	-			
Example	SK	-	20	-	S	-	P	-	202C

1	Switch rating	20 = 20A(standard) 32 = 32A(customized) 63 = 63A(customized)
2	Material	S = Stainless steel B = Brass
3	Mounting type	P = Panel mount without enclosure F = Surface mount with enclosure
4	Switch contact type and quantity	2O2C = 2 normal open & 2 normal close 4C = 4 normal close 6O = 6 normal open

Special construction available upon enquiry

ACCESSORIES

	Product	Part number
	Production cover	CAM12490(to be consulted to ARMADILLO)

CONTACT INFORMATION

WWW.ARMA-SAFETY.COM

Email: Sales@arma-safety.com

Phone: 0086(0)1531 680 2637

Address: No.2258 CaoAn Road JiaDing district Shanghai China